



ARCY-Line: CADM Commercial Downlights

2-Piece Design + Adjustable Beam Angle



Square Reflector

Detail Specification:

- Finish: White Smooth & Clear-Specular Options
- Round or Square Trims Available
- Wet Location Rated
- Field Adjustable Beam Angle: 24-45°
- Chip: COB, R9 >50, CRI >90, UGR<16
- 3 Step MacAdam Ellipses
- Operating Temperature: -40° - 114° F
- Lens: Frosted PC, non-yellowing
- Average life (L70) of 70,000 hours

Applications:

- General Recessed Lighting
- Residential & Multifamily
- Office, Hallways and Meeting Rooms
- Education, Healthcare, Retail, Hospitality
- Commercial Lighting

Product Information:

- Metal housing and trim for better heat dissipation
- Module twists and locks into the trim
- SnapTrim Canless: Spring clips with remote j-box eliminates can
- Deep reflector lens reduces glare and optimizes even beam distribution
- 3M20, 3M30, 3M35: Compatible with 4", 6", 8", 10" Trims
- 3M55: Compatible with 6", 8", 10" Trims
- Select-n-Switch Technology: 5-CCT + 3-Power Selectable

Driver Options:

- 120-277V 0-10V Dimmable down to 1%
- THD: <20% (+/-5% tolerance), PF >0.9, 50/60Hz
- Built in 2.5Kv Surge Protector
- Flicker Free

Mounting & Installation:

- Cut Out Dimensions:
 - 4": 4-3/4" -- 5-1/2"
 - 6": 6-1/8" -- 7-3/16"
 - 8": 7-1/2" -- 8-7/8"
 - 10": 9" -- 10"
- Optional new construction plate available
- This fixture does not fit into a recessed can
- No housing needed in remodel applications, tension clips mount into 1/2" to 1.5" thick ceiling
- Can be removed from below the ceiling for service or replacement
- Pre-wired junction box with circuit wiring built in (3 in / 3 out)

Certifications:

- ETL Listed for USA and CA
- Energy Star Certified
- CA Title 24 JA8-2022 CEC Listed
- 5 Year Limited Warranty
- FCC CFR 47, GCC Part 15, Subpart B:2017
- 3M20 Module is IC Rated and ASTM-E283 Air-Tight
- 3M30, 3M35, 3M55 is Non-IC
- Complies with UL 263, ASTM E119, CAN ULC S101

Modules	Voltage ¹	Emergency
LED-CADM-3M20-5CCT 10/12/20W • 750/1,000/1,500lm	UNV 120-1277V	(Blank) No Emergency
LED-CADM-3M30-5CCT 20/24/30W • 1,700/2,000/2,400lm	HV 347-480V	Backup
LED-CADM-3M35-35K 13/20/35W • 1,250/2,000/3,000lm		EMB Emergency Backup
LED-CADM-3M55-30K 32/40/55W • 3,200/4,000/5,000lm		
LED-CADM-3M55-35K 32/40/55W • 3,200/4,000/5,000lm		
LED-CADM-3M55-40K 32/40/55W • 3,200/4,000/5,000lm		

1. HV: Step down transformer into 4" j-box

Trim ²	Optional Accessories (Order Separately)			
	Goof Ring	New Construction Plates	Emergency Backup ³	Junction Box
CADM-4-CSH² 4" Round Clear-Specular Haze Reflector / White Flange	GR-4-WH 4-8" Width	CUNV-NC-ICAT-7H Universal plate w/ hanging bars	LED-EMB-8W-HV-0/10V-2P 8W Emergency Backup	JBOX-ALM Junction box with 4 1/2" knockouts
CADM-4-WH² 4" Round White Reflector White Flange	GR-6-WH 6.3-10" Width	CUNV-JBX-RI-XL Universal rough in plate. Extra long.	LED-EMB-15W-HV-0/10V-2P 15W Emergency Backup	
CADM-4-CSH-SQ² 4" Square Clear-Specular Haze Reflector / White Flange	GR-8-WH 8-12.5" Width	C4-NC-RI-J-JBX 4" plate w/ hanging boards + j-box	LED-EMB-25W-HV-0/10V-2P 25W Emergency Backup	
CADM-6-CSH 6" Round Clear-Specular Haze Reflector / White Flange	GR-10-WH 9-14.1" Width	C6-NC-RI-J-JBX 6" plate w/ hanging boards + j-box		
CADM-6-WH 6" Round White Reflector White Flange		C8/10-NC-RI-J-JBX 8 & 10" plate w/ hanging boards + j-box		
CADM-6-CSH-SQ 6" Square Clear-Specular Haze Reflector / White Flange				
CADM-8-CSH 8" Round Clear-Specular Haze Reflector / White Flange				
CADM-8-WH 8" Round White Reflector White Flange				
CADM-8-CSH-SQ 8" Square Clear-Specular Haze Reflector / White Flange				
CADM-10-CSH 10" Round Clear-Specular Haze Reflector / White Flange				
CADM-10-WH 10" Round White Reflector / White Flange				

2. Only compatible with 3M20 & 3M30
3. Field installable. Lasts 90 minutes.

Specs and model numbers are subject to change with or without notice.

FEATURES



DIMENSIONS

DOWNLIGHT MODULE

3M55

Compatible with 6", 8", 10"

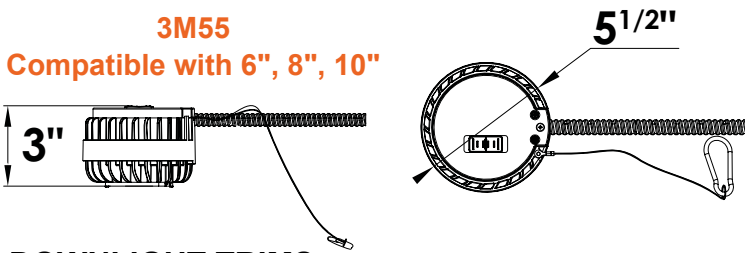

3M20, 3M30 & 3M35
Compatible with 4", 6", 8", 10"

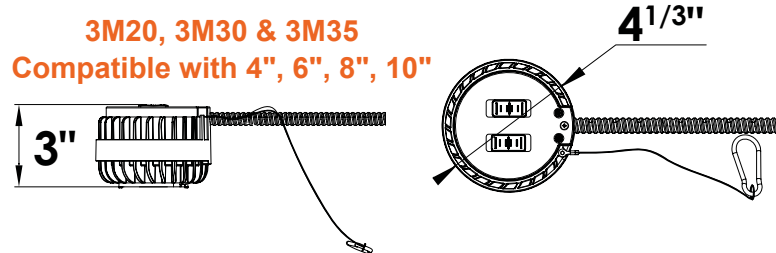

DOWNLIGHT TRIMS

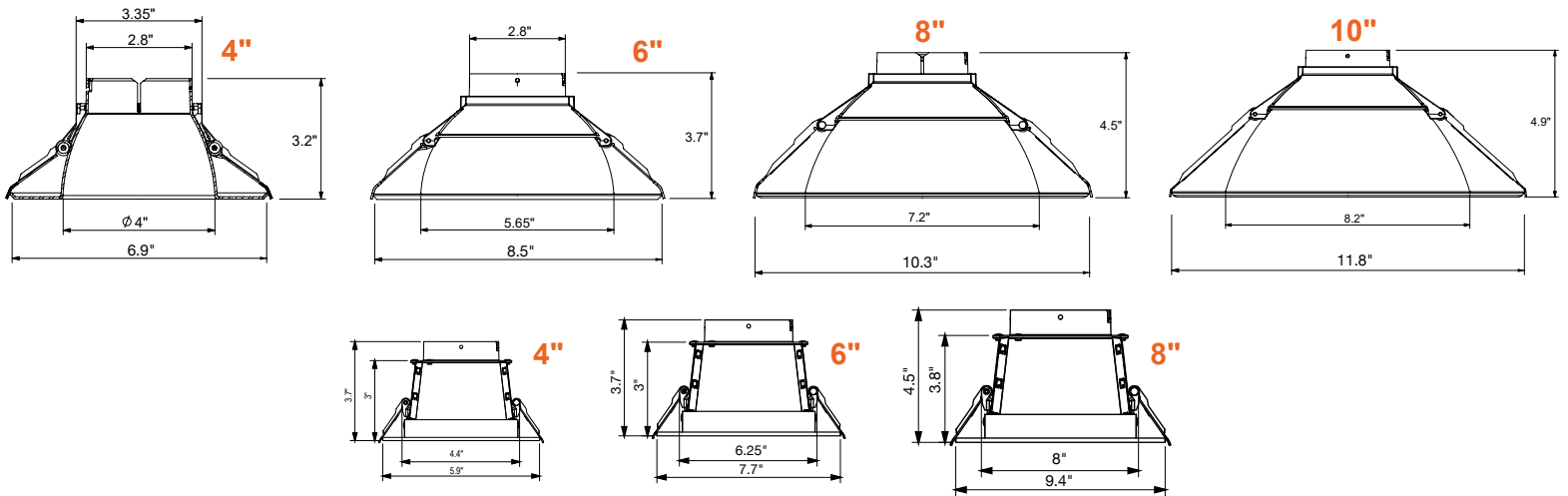

ACCESSORIES

TRIMS



CSH



WH



SQ

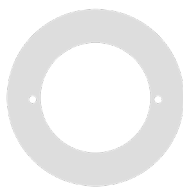

GR-4-WH
GR-6-WH
GR-8-WH
GR-10-WH

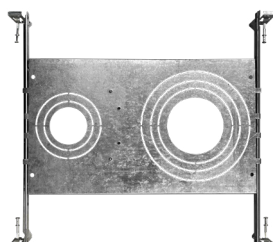

CUNV-NC-ICAT-7H
Universal Pre-Mounting Plate
13 7/8" x 15 1/8"

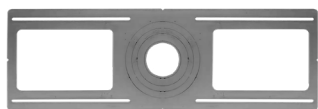

CUNV-JBX-RI-XL
7" x 26"

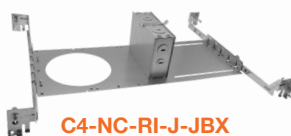

C4-NC-RI-J-JBX
17" W x 6.5" D x 3.5" H
5" Hole
14" Min. Extend
25" Max. Extend
(Assembly Required)

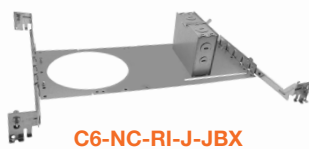

C6-NC-RI-J-JBX
18.5" W x 9" D x 4" H
6.25" Hole
14.25" Min. Extend
25" Max. Extend
(Assembly Required)



C8/10-NC-RI-J-JBX
18.5" W x 12" D x 4" H
8" Hole
14" Min. Extend
25" Max. Extend
(Assembly Required)



LED-EMB-8W-HV-0/10V-2P
LED-EMB-15W-HV-0/10V-2P
LED-EMB-25W-HV-0/10V-2P

DOWNLIGHT MODULE

Model	Voltage	Watts	Lumens	Color	CRI
LED-CADM-3M20-5CCT-UNV	120-277V	10/12/20w	750/1000/1500lm	27/30/35/40/50K	>90
LED-CADM-3M30-5CCT-UNV	120-277V	13/20/35w	1250/2000/3000lm	27/30/35/40/50K	>90
LED-CADM-3M35-35K-UNV	120-277V	13/20/35w	1250/2000/3000lm	3500k	>90
LED-CADM-3M55-30K-UNV	120-277V	32/40/55w	3200/4000/5000lm	3000k	>90
LED-CADM-3M55-35K-UNV	120-277V	32/40/55w	3200/4000/5000lm	3500k	>90
LED-CADM-3M55-40K-UNV	120-277V	32/40/55w	3200/4000/5000lm	4000k	>90

TRIMS

Model	Description
CADM-4-CSH	4" Round Clear-Specular Haze Reflector / White Flange
CADM-4-WH	4" Round White Reflector / White Flange
CADM-4-CSH-SQ	4" Square Clear-Specular Haze Reflector / White Flange
CADM-6-CSH	6" Round Clear-Specular Haze Reflector / White Flange
CADM-6-WH	6" Round White Reflector / White Flange
CADM-6-CSH-SQ	6" Square Clear-Specular Haze Reflector / White Flange
CADM-8-CSH	8" Round Clear-Specular Haze Reflector / White Flange
CADM-8-WH	8" Round White Reflector / White Flange
CADM-8-CSH-SQ	8" Square Clear-Specular Haze Reflector / White Flange
CADM-10-CSH	10" Round Clear-Specular Haze Reflector / White Flange
CADM-10-WH	10" Round White Reflector / White Flange

GOOF RING

Accessory Model	Description
GR-4-WH	4" Goof Ring, Inner Dim: 6.3" Outer Dim: 10.5"
GR-6-WH	6" Goof Ring, Inner Dim: 6.3" Outer Dim: 10.5"
GR-8-WH	8" Goof Ring, Inner Dim: 8" Outer Dim: 12.5"
GR-10-WH	10" Goof Ring, Inner Dim: 9" Outer Dim: 14.1"

NEW CONSTRUCTION PLATES

Accessory Model	Description
CUNV-NC-ICAT-7H	Universal plate w/ hanging bars
CUNV-JBX-RI-XL	Universal tough in plate. Extra long
C4-NC-RI-J-JBX	4" plate w/ hanging bars + j-box
C6-NC-RI-J-JBX	6" plate w/ hanging bars + j-box
C8/10-NC-RI-J-JBX	8 & 10" plate w/ hanging bars + j-box

BATTERY BACK-UP

Accessory	Description
LED-EMB-8W-HV-0/10V-2P	8W Emergency Backup
LED-EMB-15W-HV-0/10V-2P	15W Emergency Backup
LED-EMB-25W-HV-0/10V-2P	25W Emergency Backup

JUNCTION BOX

Accessory	Description
JBOX-ALM	Junction box with 4 1/2" knockouts



J-BOX ALM
4.46" W x 3.04" D x 1.37" H

TESTED COMPATIBLE DIMMERS

Other dimmers may be compatible but have not been tested. Please contact us for more information.

Brand	Item#	Brand	Item#
Synergy	ISD BC 120/277 WH	Leviton	IP710-DLZ
Eaton	SF10P-W	Lithonia Lighting	ISD BC 120/277 WH
Lutron	DVSTV-WH		