

Smart Monitor Plugs & Connectors Constantly Monitor These Conditions:

- No Ground
- Loss of Ground In Cord
- Hot/Neutral Swap
- Reverse Polarity
- Hot on Ground
- Open Neutral

Features Of All Smart Monitor Plugs & Connectors:

- Super Bright LED Technology
- Smart Monitor Module
- Keyed body and cover
- Easy to wire
- Clear internal wiring cover
- Non-slip finger grips
- Color coded terminal screws
- Multiple cord grommets included
- Rubberized outer body
- Safety Yellow and Blue body

ERICSON EXCLUSIVE

"LIKE HAVING A METER IN EVERY PLUG..."

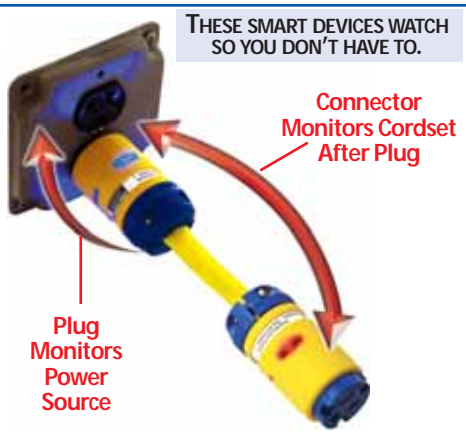
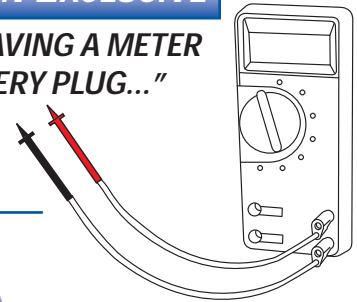

BLUE
OK TO USE

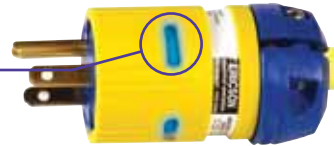

LEDs light up to let you know power is O.K.



24/7
Monitoring



RED
STOP, CALL AN
ELECTRICIAN!

LEDs light up to let you know there is a problem

- No Ground
- Loss of Ground In Cord
- Hot/Neutral Swap
- Reverse Polarity
- Hot on Ground
- Open Neutral

How It Works - Diagnostic Safety Cords

Economy Safe Cords

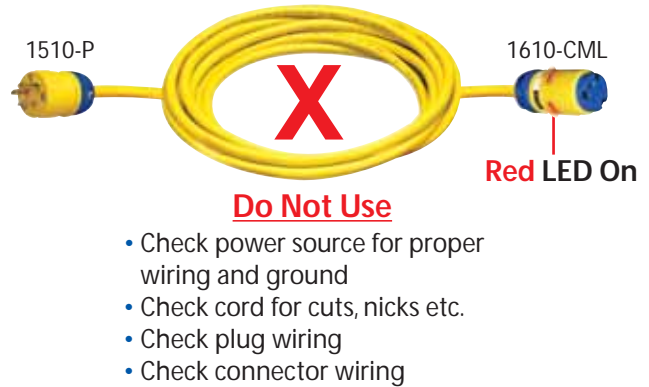

Full Diagnostic Safety Cords*



Blue OK to use tool**

Red STOP!

- Check power source for wiring or missing earth ground
- Check for miswired receptacle

* Full diagnostic safety cords give easy-to-understand indications which saves time tracking down electrical safety issues.

**This device does not diagnose any tool internal issues. This device is an indication that the power and safety earth ground are present.

Smart Monitor Series

Cord Clamp Style



Perma-Link™ Cord Clamp Style Features:

- Internal cord seal
- Dual screw self-centering clamp
- Rubberized outer body

XXXX-PML

Cord Grip Style



Perma-Grip™ Cord Grip Nut Style Features:

- Nickel plated solid brass blades
- Super sealing cord grip nut design



XXXX-PMGL

Water Tight Style



Perma-Tite2™ All Weather Cord Grip Nut Style features:

- All weather - NEMA 6P rated
- Super sealing rings
- Nickel plated solid brass blades
- Super sealing cord grip nut design
- Connector includes cover
- 360° indication

XXXX-CW6PL

Plug & Connector Selection Guide

Face View	NEMA Configuration	Electrical Ratings		Perma-Link®		Perma-Grip®		Perma-Tite® 2	
		Amps	Volts	Plugs	Connectors	Plugs	Connectors	Plugs	Connectors
Straight Blade, 2-pole, 3-wire Grounding Devices									
	5-15	15	125	1510-PML	1610-CML	1510-PMGL	1610-CMGL	1510-PW6PL	1610-CW6PL
	5-20	20	125	1512-PML	1612-CML	1512-PMGL	1612-CMGL	1512-PW6PL	1612-CW6PL
Locking, 2-pole, 3-wire Grounding									
	L5-20	20	125	2310-PML	2410-CML	2310-PMGL	2410-CMGL	2310PW6PL	2410-CW6PL
	L5-15	15	125	1520-PML	1620-CML	1520-PMGL	1620-CMGL	1520-PW6PL	1620-CW6PL

New From Ericson... Industrial application SmartCords factory built to last and last. Models with Smart Connector (Economy Safe) and both Smart Plug and Connector are available. 24/7 monitoring with Assured Grounding Compliance to NEC and OSHA standards. Built with the highest quality materials to withstand your environment.



1510PML123A shown

Cord

Tough 600V rated SOW cordage for long lasting wear

Smart Monitor Connector

Checks entire cordset from the plug to the connector

Cordset Selection Guide

Economy Safe SmartCords P/N*	Length	Non-smart PLUG	Smart Connector	Cord Size	Rating
1610XXX143	A = 25ft B= 50ft D=100ft	1510-__	1610-__L	#14/3 SOW	15A
1610XXX123		1510-__	1610-__L	#12/3 SOW	15A
1612XXX123		1510-__	1610-__L	#12/3 SOW	20A
2410XXX123		2310-__	2410-__L	#12/3 SOW	20A
Note: plug and connector type will be based on selection made of the master cordset part number - style will match					
Full Diagnostic Safety SmartCords P/N**	Length	Smart PLUG	Smart Connector	Cord Size	Rating
1510XXX143	A = 25ft B= 50ft D=100ft	1510-__L	1610-__L	#14/3 SOW	15A
1510XXX123		1510-__L	1610-__L	#12/3 SOW	15A
1512XXX123		1512-__L	1610-__L	#12/3 SOW	20A
2310XXX123		2310-__L	2410-__L	#12/3 SOW	20A
Note: plug and connector type will be based on selection made of the master cordset part number					

* Replace XXX with: (Economy Cordsets Only)

CML = PermaLink Style Light Industrial Wiring Devices (non-smart Plug and Smart Connector installed)

CMGL = PermaGrip Style Industrial Wiring Devices with nickel plated blades (non-smart Plug and Smart Connector installed)

CW6PL = PermaTite Style Industrial All-Weather Wiring Devices (non-smart Plug and Smart Connector installed)

** Replace XXX with: (Full Diag Cordsets Only)

PML = PermaLink Style Light Industrial Wiring Devices (Smart Plug and Smart Connector installed)

PMGL = PermaGrip Style Industrial Wiring Devices with nickel plated blades (Smart Plug and Smart Connector installed)

PW6PL = PermaTite Style Industrial All-Weather Wiring Devices (Smart Plug and Smart Connector installed)



WIRING DEVICES