

# ASPEN *Xtra* ACCESSORY TOOL BOX



ACCESSORY TOOL BOX			
Code	Model	Description	Qty.
83999	AX00051/R	12 section fitting and accessory box (18"x14"x3")	1

ACCESSORY TOOL BOX CONTENTS LISTING			
Code	Model	Description	Qty.
Mini Pump Rubber Adapter/Connector			
83970	FP2001	5/8" mini pump to 3/4" ducted drain (16mm-20mm)	Qty 2
83971	FP2002	5/8" mini pump to 1" ducted drain (16mm-25mm)	Qty 2
83972	FP2003	5/8" mini pump to 1-1/4" ducted drain (16mm-32mm)	Qty 2
Mini Pump 90° Long Arm Bend Connector			
83973	FP2006	1/2" to 5/8" (12mm-16mm) long arm	Qty 2
Pipe to Pipe Rubber Connector/Adapter			
83977	FP2042	3/4" PVC to 5/8" (20mm-16mm)	Qty 2
83978	FP2044	3/4" PVC to 1" (20mm-25mm)	Qty 2
83979	FP2046	3/4" PVC to 1-1/4" (20mm-32mm)	Qty 2
Hose to Hose Connectors			
83984	FP2024	1/4" "T" connectors (6mm)	Qty 3
83985	FP2028	1/4" elbow connectors (6mm)	Qty 4
83986	FP2622	1/4" straight connectors (6mm)	Qty 3
83987	FP2030	3/8" "T" connectors (10mm)	Qty 3
83988	FP2032	3/8" elbow connectors (10mm)	Qty 3
83989	FP2624	3/8" straight connectors (10mm)	Qty 3
Tube Adapter/Fitting			
83990	FP2038	3/8" or 1/4" (10mm/6mm) self sealing soil pipe connector	Qty 2
Check Valves			
83982	FP2628	1/4" Non Return Valves (6mm)	Qty 2
83983	FP2630	3/8" Non Return Valves (10mm)	Qty 2

# ASPEN *Xtra* DISPLAY STANDS

For accessory selection and pricing, ask your Rectorseal distributor, or scan code below.



83967 - AX0600  
Aspen Xtra Small Counter Stand



83968 - AX0700  
Aspen Xtra Medium Floor Stand



83969 - AX0800  
Aspen Xtra Large Floor Stand



# Xtra



**COMPLETE** ACCESSORY LINE FOR DUCTLESS A/C EQUIPMENT INSTALLATION

Everything to do the job right!



SOLD AS:

- Multi-Packs
- Tool Box Kit
- Counter Display
- Floor Display

# ASPEN *Xtra* ACCESSORIES

All accessories are multi-packed in transparent POP ready poly bags.



Code	Model	Description	Units/Bag	Bags/Carton
		<b>Rubber adapter -</b> Connects a ducted unit to a Mini Pump Reservoir.		
83970	FP2001	5/8" mini pump to 3/4" ducted drain (16mm-20mm)	Qty 3	Qty 10
83971	FP2002	5/8" mini pump to 1" ducted drain (16mm-25mm)	Qty 3	Qty 10
83972	FP2003	5/8" mini pump to 1-1/4" ducted drain (16mm-32mm)	Qty 3	Qty 10
		<b>90° Long Arm Bend -</b> Connects a Wall Mount to Mini Pump Reservoir.		
83973	FP2006	1/2" to 5/8" (12mm-16mm) long arm	Qty 3	Qty 10
		<b>Rubber Adapter -</b> Connects a Cassette Unit Condensate Drain Pipe to a Tank Pump.		
83974	FP2011	5/8" cassette unit outlet to 3/4" hose (16mm-20mm)	Qty 3	Qty 10
83975	FP2012	1" cassette unit outlet to 3/4" hose (25mm-20mm)	Qty 3	Qty 10
83976	FP2013	1-1/4" cassette unit outlet to 3/4" hose (32mm-20mm)	Qty 3	Qty 10
		<b>Pipe to Pipe Rubber Connector/Adapter -</b> Connect 3/4" PVC Overflow Pipe to Waste Pipe.		
83977	FP2042	3/4" PVC to 5/8" (20mm-16mm)	Qty 3	Qty 10
83978	FP2044	3/4" PVC to 1" (20mm-25mm)	Qty 3	Qty 10
83979	FP2046	3/4" PVC to 1-1/4" (20mm-32mm)	Qty 3	Qty 10
		<b>Tube Connector Fitting and Straight Reducer -</b> In-line junction for mismatched tubing.		
83980	FP2020	3/8" to 1/4" straight reducer (10mm to 6mm)	Qty 5	Qty 10
83981	FP2632	5/8" to 1/4" reducing connector (16mm-6mm)	Qty 5	Qty 10
		<b>Hose to Hose Connector -</b> In-line junction for matched size tubing.		
83984	FP2024	1/4" "T" connectors (6mm)	Qty 5	Qty 10
83985	FP2028	1/4" elbow connectors (6mm)	Qty 5	Qty 10
83986	FP2622	1/4" straight connectors (6mm)	Qty 5	Qty 10
83987	FP2030	3/8" "T" connectors (10mm)	Qty 5	Qty 10
83988	FP2032	3/8" elbow connectors (10mm)	Qty 5	Qty 10
83989	FP2624	3/8" straight connectors (10mm)	Qty 5	Qty 10
		<b>Mini Pump Pre-Filter -</b> Protects mini pump from condensate debris.		
83893	FP2040	5/8" Pre-filter for Aspen Mini Pumps	Qty 3	Qty 10

Code	Model	Description	Units/Bag	Bags/Carton
------	-------	-------------	-----------	-------------

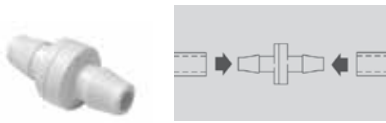

**Check Valve Connector/Fitting -**  
Prevents back-flow of condensate.

83982	FP2628	1/4" Non Return Valves (6mm)	Qty 5	Qty 10
83983	FP2630	3/8" Non Return Valves (10mm)	Qty 5	Qty 10

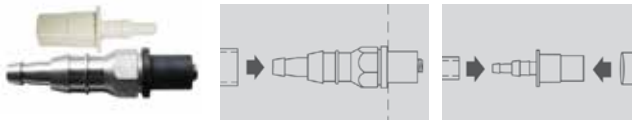

**Tube Adapter -**  
Connects discharge condensate to waste/soil pipe

83991	FP2040	3/4" to 3/8" or 1/4" (20mm-10mm or 6mm)	Qty 3	Qty 10
83990	FP2038	3/8" or 1/4" self sealing soil pipe connector (10mm/6mm)	Qty 3	Qty 10

**ASPEN Xtra PIPE SUPPORTS**

All pipe supports are multi-packed in transparent POP ready poly bags.



Code	Model	Description	Units/Bag	Bags/Carton
------	-------	-------------	-----------	-------------

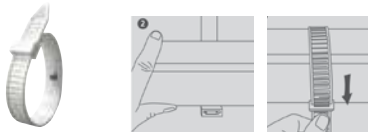

**Pipe Ties -**  
Wide & Rugged. Perfect for multiple insulated linesets.

83998	B6414	T400 white 15-3/4" long by 3/4" wide	Qty 10	Qty 10
-------	-------	--------------------------------------	--------	--------



**Metal Pipe Hanger -**  
Designed for supporting lineset pairs.

83992	B6492	Fits 3/8" liquid & 5/8" gas pipes (incl. insulation)	Qty 10	Qty 10
83993	B6494	Fits 5/8" liquid & 1-1/8" gas pipes (incl. insulation)	Qty 10	Qty 10



**Grip Locks -**  
Versatile. Mounts to any surface. Ideal for insulated linesets.

83996	B6188	Fits 1/2" liquid & 7/8" gas pipe (incl. insulation)	Qty 10	Qty 10
83997	B6189	Fits 5/8" liquid & 1-1/8" gas pipe (incl. insulation)	Qty 10	Qty 10

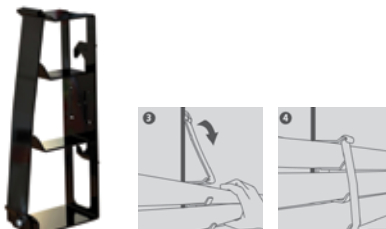

**Three Pipe Clip -**  
Supports VRV / VRF systems insulated linesets.

83994	B6362	For pipe groups 1/2", 3/4", 1-1/8", to 5/8", 1", 1-1/8"	Qty 5	Qty 10
83995	B6364	For pipe groups 7/8", 1-1/8", 1-3/8" to 3/4", 1-3/8", 1-5/8"	Qty 5	Qty 10